

SR-IR145

INFRARED ROAD STUD FOR ENFORCEMENT SYSTEMS
YOUR SAFETY EYES

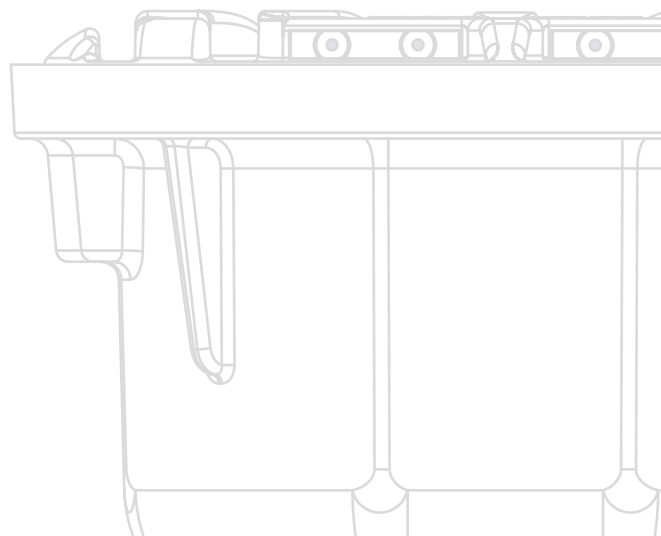

SR-IRL45



INFRARED ROAD STUD FOR ENFORCEMENT SYSTEMS

The **Infrared Road Stud for Speed Enforcement System** is intended to enlighten and enable the identification of car plates exceeding the speed limit.

When a vehicle over the speed limit - detected by any speed enforcement system - is getting closer, the SR-IRL45 illuminates the car plate allowing a more effective night reading. The light projection is performed from the bottom up allowing a higher efficiency in the area of interest - the car plate.

KEY FEATURES

- Robust construction, suitable for harsh conditions
- 100% waterproof
- Low maintenance
- Possibility of integration with enforcement systems
- Unidirectional operation
- LEDs protected by polycarbonate window
- IR light source with high efficiency
- Centroid wavelength 850nm
- Remote controlling
- Variable brightness
- Constant current drivers to increase lifetime of LEDs
- Operation Mode: Always on, Flashing, Sequential (with external controller)

SPECIFICATIONS:

ELECTRICAL

Power Supply: 24Vdc

Power Consumption: 12.65W

OPTICAL

LEDs Number: 4 LEDs

LEDs Wavelength: 850nm

Viewing Angle: 150°

Radiant Intensity: Min.: 160mW/sr | Max.: 320mW/sr

MECHANICAL

Dimensions: Ø160.5mm x 100.5mm

Weight: 2.5kg

Minimum Installation Depth: 100mm

Bottom Part Material: Aluminum

Top Material: Steel/Polycarbonate Window

Mechanical Resistance: 30 Tons

Protection Index: IP68 and IK10

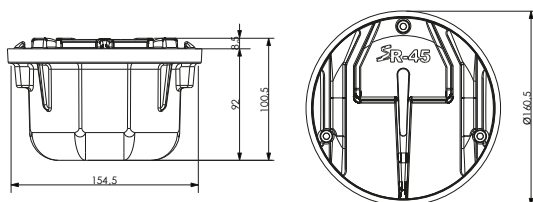
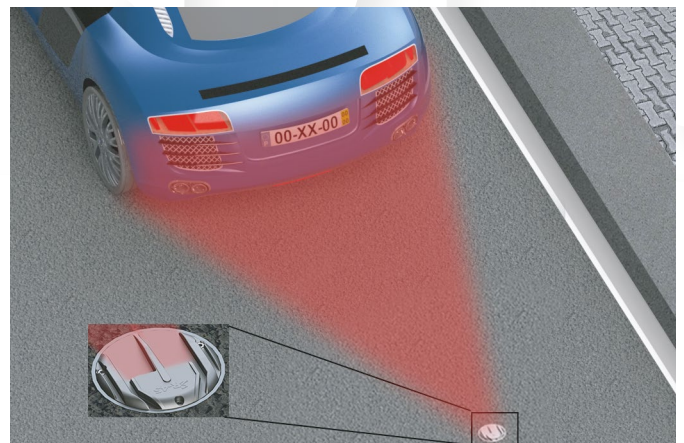
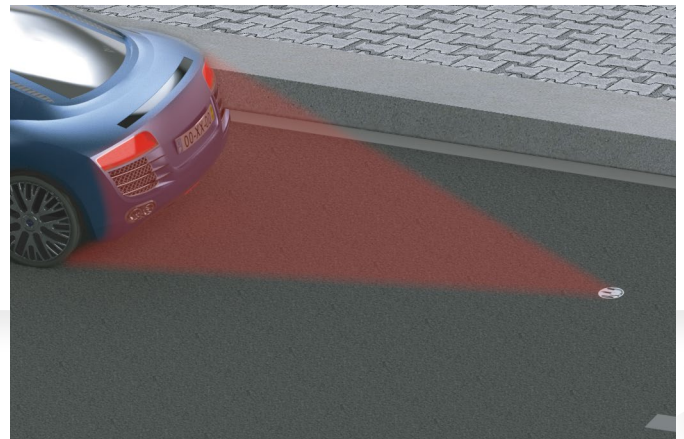

Dimensions: mm

