

# SR-48P



## Hardwired Road Stud with Power Led's

### KEY FEATURES

- Suitable for regular traffic areas of heavy vehicles
- High mechanical resistance: 90 Tons
- Ready for snow plough machines
- Robust construction, suitable for harsh conditions.
- Rising from road surface of 8,5mm
- High power led's with 1W each
- High visibility due to power led's even in adverse weather conditions
- It allows drivers a higher reaction time due to the lighting range
- High brightness during day and night
- Possibility of connection of **N** elements
- Possibility of different color LEDs per window
- Easy maintenance

### MODES OF OPERATION

Always On

\*Other modes of operation like flashing or sequential are available with external controller

### LED'S CONFIGURATION

Bidirectional

### ELECTRICAL FEATURES

Power Supply	24V DC
Current Consumption	200 mA <sup>1</sup>
Power Cable	Wire 1 (+)   Wire 2 (-)   Wire 3 (PWM)
Working Temperature	-25 °C to +85°C

<sup>1)</sup> Maximum power consumption.

### OPTICAL FEATURES

Led Quantity  
4 Led's

Led Type  
Power Led

Led Colors  
White, Warm White, Red, Amber, Green,  
Blue

Viewing Angle  
16°

### MECHANICAL FEATURES

Material  
**Bottom Part:** Aluminum  
**Top Part:** Hard stainless steel league with  
good corrosion resistance and  
polycarbonate window

Mechanical Resistance  
90 Tons

Weight  
2,7 Kg

Protection Index  
IP68, IK10

Dimensions  
Ø160,5 x 100,5 mm

# SR-48P



## PWM DIMMING CONTROL

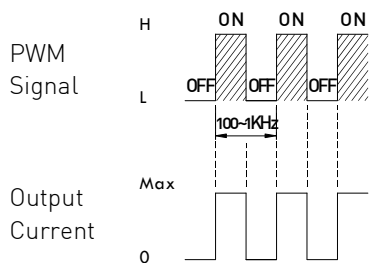

During PWM dimming operation, the output current will change to PWM style.

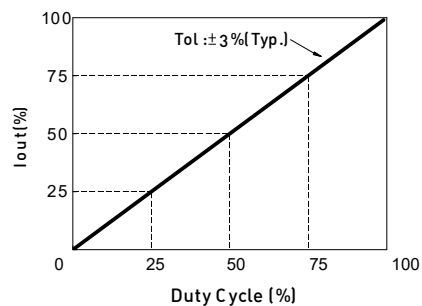

## STANDARD APPLICATION

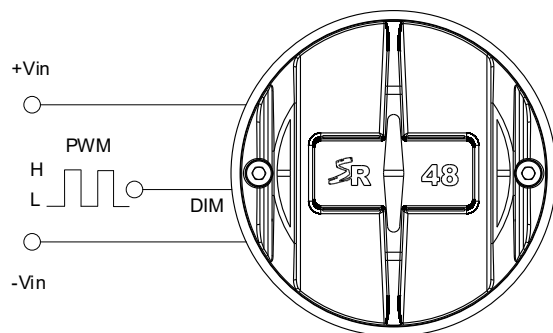

<b>PWM DIMMING &amp; ON/OFF CONTROL</b>	REMOTE ON/OFF	Leave open if not use
		Power ON with dimming: DIM ~ H >2.5 ~ 6VDC or open circuit
		Power OFF : DIM ~ H < 0.8VDC or short to -Vin
	PWM FREQUENCY	100 ~ 1KHz
	QUIESCENT INPUT CURRENT IN SHUTDOWN MODE[max.]	1mA at PWM dimming OFF and 24VDC input

# SR-48P



## DIMENSIONS (mm)

### SR-48P ROAD STUD

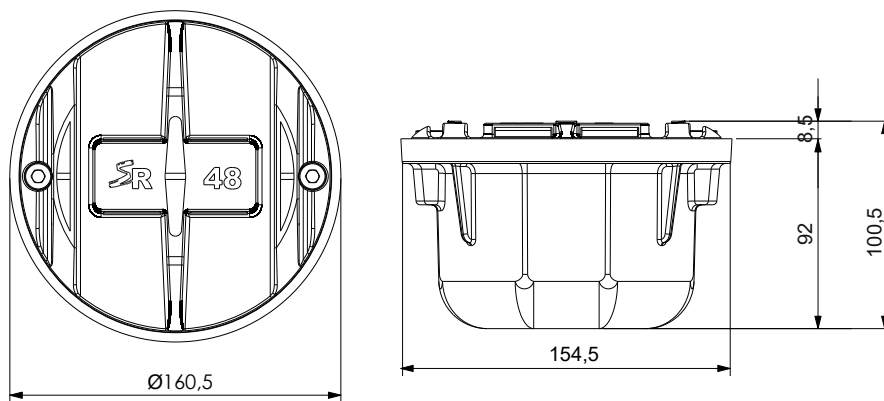

### ACESSÓRIO DE INSTALAÇÃO SR-SFT4

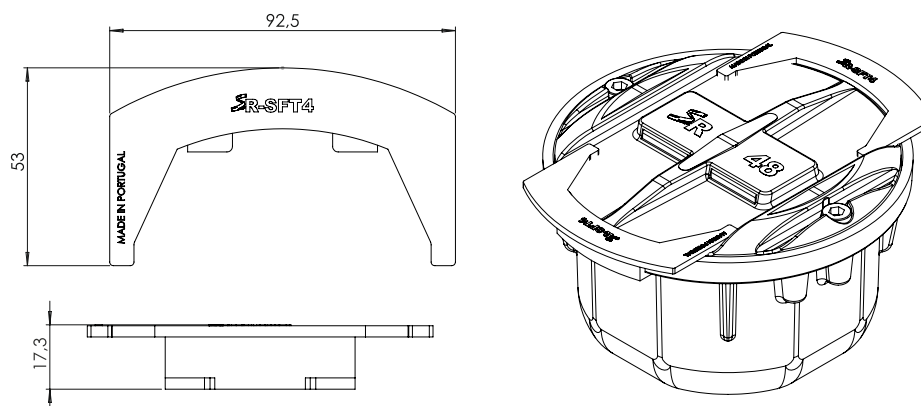

# SR-48P



## INSTALLATION PROCEDURE



To do the installation Personal Protective Equipment must be worn during all process.

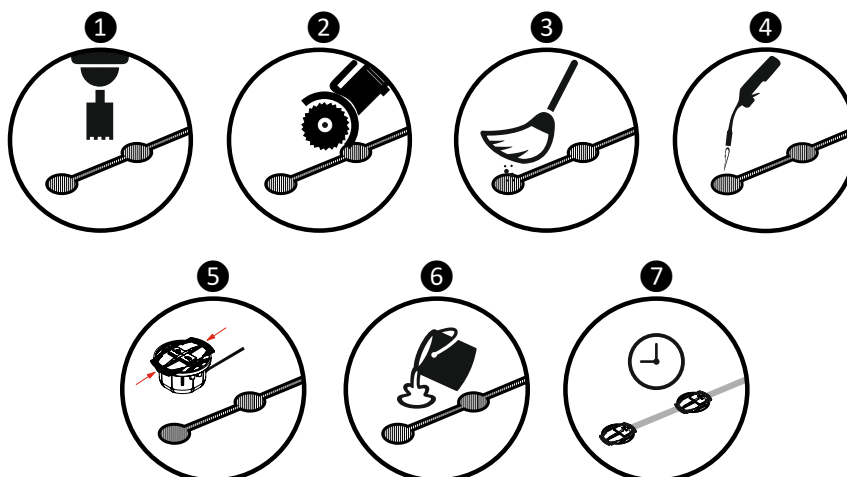

- 1 After deciding the location where the stud will be installed, drill a hole having a minimum diameter of 165 mm and 100 mm deep.
- 2 Using a disk cutter, open a connection between the holes with 15mm width and 60mm depth.
- 3 Brush any debris or dust from the hole resulting from drilling.
- 4 Dry the hole with a blowtorch to remove any moisture that may compromise the adhesion and effectiveness of the glue.
- 5 Apply in each installed that will be installed the SR-SFT4 installation accessory. The accessory will help to align e keep the road stud in place during the glue drying time. This accessory will be removed at the end of the installation
- 6 Pour  $\pm 2,5$ Kg of glue **Sikadur 42 SP** in the hole and insert the stud checking that the led's are facing the right way. Remove any excess remaining of glue.
- 7 The glue drying time may change depending on weather conditions. Consult the glue data sheet for more information.  
After the glue has dried, the top part of the SR-SFT4 accessory should be broken and removed.

Changing or not fulfillment of the described installation process can result in suspension of warranty.